

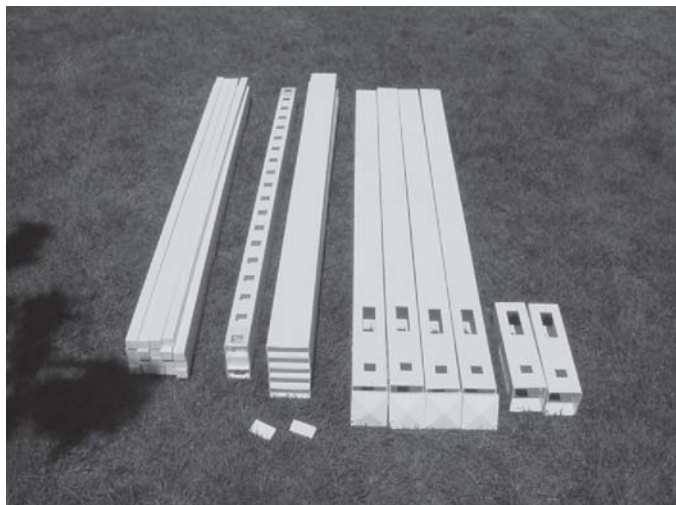

Palomar Installation Instructions

Palomar Parts List



Standard Items

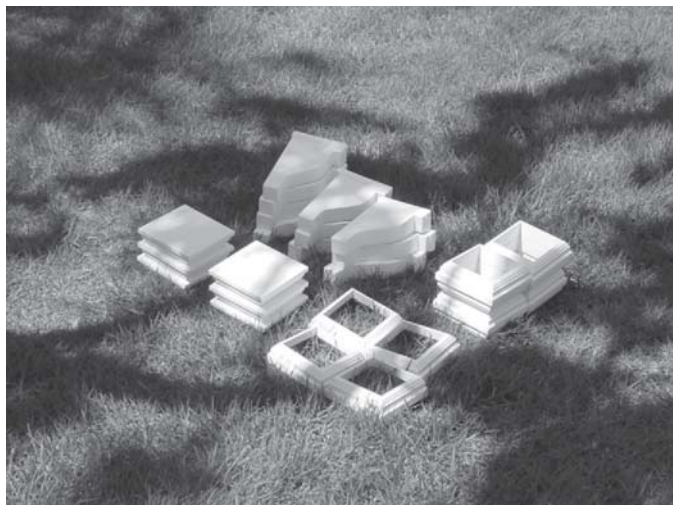

Optional Items

5"x 5" Support Posts: Qty. ____

8' 10'

5"x 5" Interim Posts: Qty. ____

2"x 6" Rafters: Length ____ Qty. ____

2"x 6" Rafters: Length ____ Qty. ____

2"x 6" Rafters: Length ____ Qty. ____

2"x 3.5" Batten Holders: Length ____ Qty. ____

2"x 3.5" Batten Holders: Length ____ Qty. ____

1 3/4"x 1 3/4" Battens: Length ____ Qty. ____

1 3/4"x 1 3/4" Battens: Length ____ Qty. ____

2"x 3.5" End Caps: Qty. ____

2"x 6" End Caps: Qty. ____

5"x 5" Post Caps: Qty. ____

10x20 Cad Plated Screws: Qty. ____

2"x 6" Corbels: Qty. ____

5"x 5" Base Trim: Qty. ____

5"x 5" Post Trim: Qty. ____

5"x 5" _____ Post Caps: Qty. ____

Tools Required

Carpenters level
Power driver
12" Driver extension
#2 Phillips screw driver tip
Tape measure

Your Palomar Structure is a ready to assemble kit.

If you have any questions regarding assembly, or if you have damaged or missing parts, please call Finyl Vinyl at (877) 933-6846 ext. 209.

Post Layout

Layout post pattern as shown.
Fasten posts per instructions.

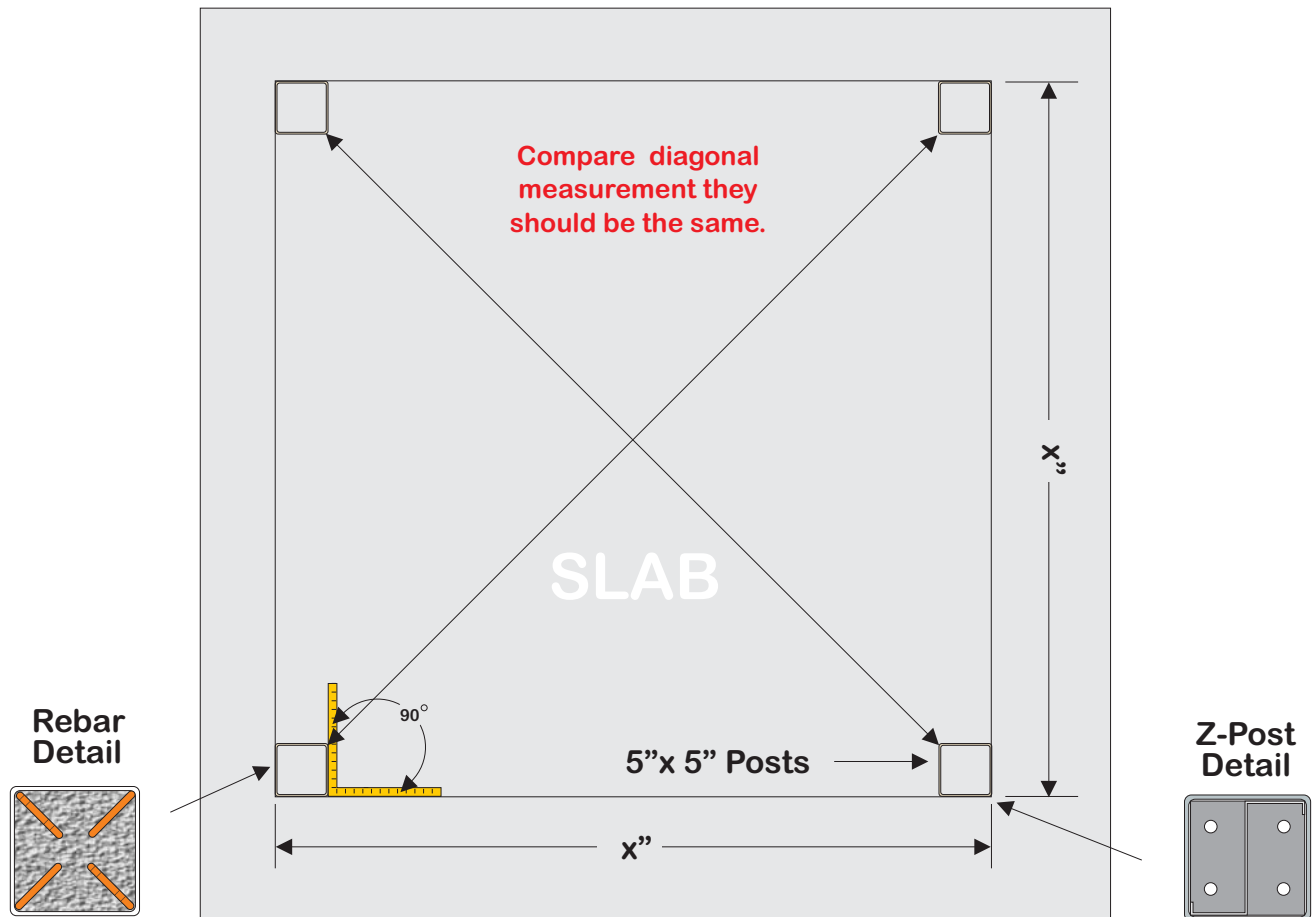

Determine the post to post dimensions for your style patio cover kit from the footprint drawing provided. Mount the posts as shown on page 4, using option 1 or 2. Once posts are in place continue with the installation of top members.

Post Trim Instalation

If your kit was ordered with the post or base trim options, slide these trim pieces onto the post as shown before continuing to the next step.

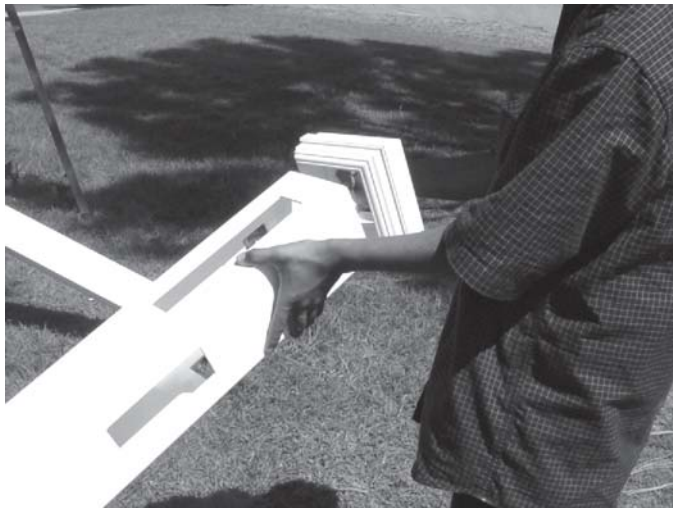
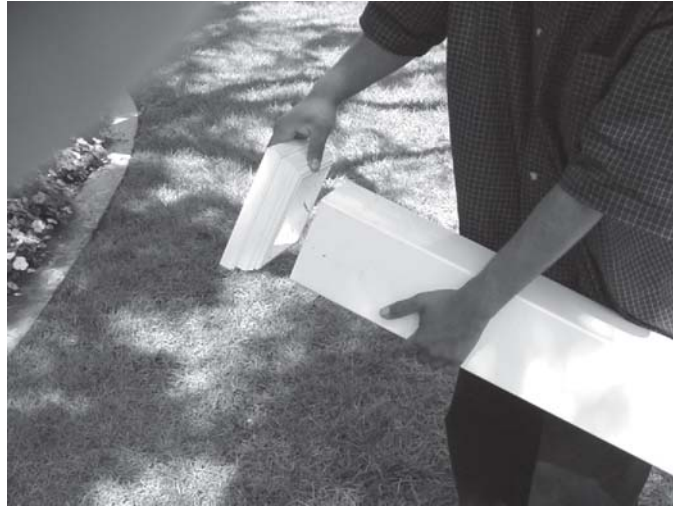

Post Mounting Options

Post Mounting Option 1 (Z-Brace Kit)

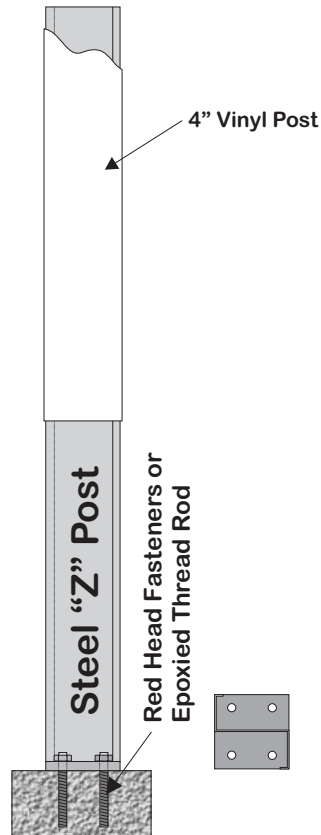

Mark concrete slab where Z-Posts are to be installed. Drill .50" holes approximately 4" deep into slab. Use air to clean out holes. Insert and set Red Head fasteners (included) or epoxy thread rod into holes. (Use SET epoxy compound by Simpson.)

Sleeve 4" vinyl posts over Z-Posts and continue with installation.

Post Mounting Option 2

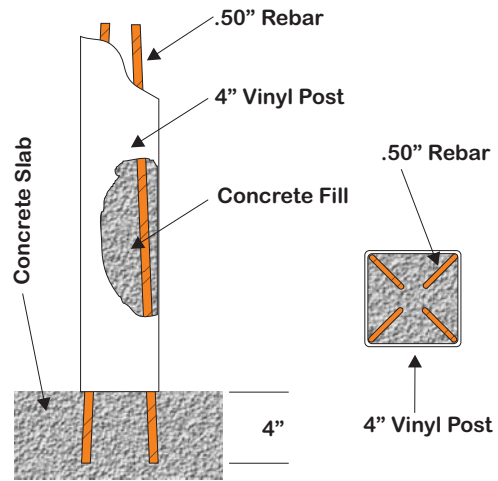

Mark concrete slab where rebar is to be installed. Drill .50" holes approximately 4" deep into slab. Use air to clean out holes. Insert & epoxy 60" long rebar into holes. (Use SET epoxy compound by Simpson.)

Sleeve 4" vinyl posts over rebar and fill with concrete. (Mix concrete according to job requirements. If the project will require movement of the posts mix the concrete slurry to a loose consistency so it does not set up too quickly.)

Important: When setting posts make sure that the orientation of the posts is correct. The rafter slots must be properly aligned or the assembly can not be completed. See photo of completed structure on next page to get alignment details.

Palomar Assembly Full View



Important: When setting posts make sure that the orientation of the posts is correct. The rafter slots must be properly aligned or the assembly can not be completed. See photo above for complete alignment details.

Rafter Assembly

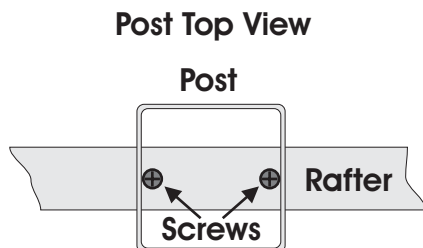
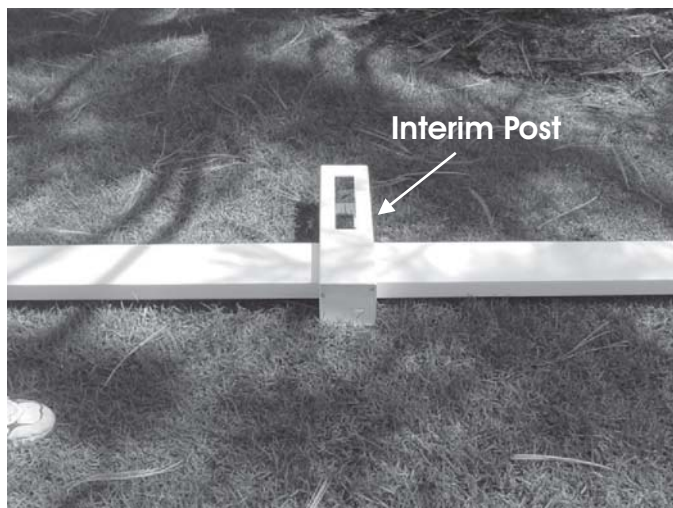

Slide short interim post onto rafter. Do not fasten at this time. Slide rafter assembly into slots provided at top of posts.

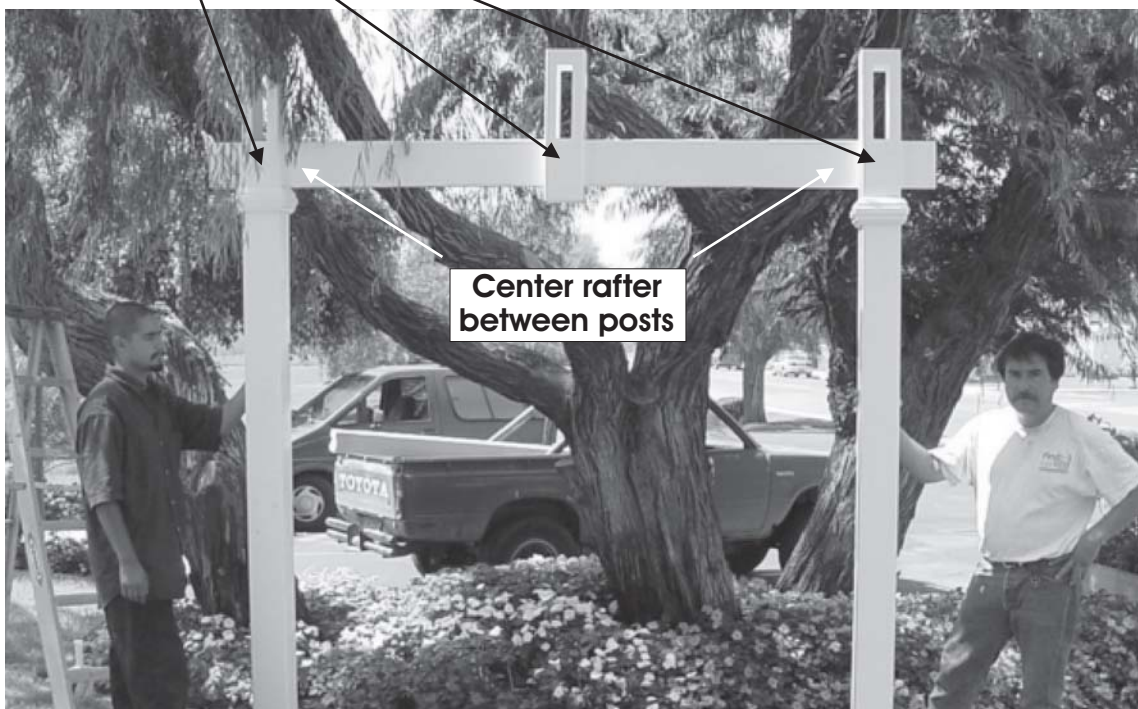

Repeat operation on other set of posts. Center rafters and fasten with screw provided through the top of the post. Center interim post on rafter between posts and fasten with screw through top of post.

Rafter Assembly Continued

slide upper rafters into place through upper holes provides as shown below.



Picket Assembly

Slide picket support rafters into place through holes provides as shown below.



Align picket holes as shown

Insert pickets below.



Picket Assembly Continued

Center and align pickets as shown below.



Structure should look as pictured below at this point.



Final Trim Assembly

Glue end caps and post caps into place.
Note: The standard kits come with flat rafter end caps and pyramid post caps. Optional corbel rafter ends and New England caps are shown



Finish your Palomar unit by cleaning with soft non abrasive soap and water.
If there are hard to remove spots or dirt on your unit, they may be removed with a light application of Laquer Thinner and a soft clean cloth.